

12 VOLT & 110 VOLT DIAPHRAGM PUMPS

12 VOLT PUMPS



5500 SERIES



FATBOY SERIES

**WIRE LOOM
WITH TOGGLE
SWITCH**

**PART NO: SP-8
LIST PRICE: \$64.63**

PART NUMBER	VOLT	AMP	GPM	PSI	POWER	VALVE	DIAPHRAGM	PORTS	LIST PRICE
2452-111-10B	12V	4.5	1.6	100	Demand/Bypass	Viton®	Santoprene	3/8" Hose Barb	\$83.51
3313-1E1-82B	12V	6	2.2	60	Demand	Viton®	Santoprene	3/4" Quick Attach	\$121.90
5516-1E1-82B	12V	11	4.0	60	Demand	Viton®	Santoprene	3/4" Quick Attach	\$291.02
5516-2E1-63B	12V	11	4.0	60	Bypass	Viton®	Santoprene	3/4" Quick Attach	\$291.02
5517-1E1-82B	12V	16	5.3	60	Demand	Viton®	Santoprene	3/4" Quick Attach	\$303.11
5517-2E1-63B	12V	16	5.3	60	Bypass	Viton®	Santoprene	3/4" Quick Attach	\$319.24
5537-1E1-82B	12V	16	5.3	60	Demand	Viton®	Santoprene	1/2" Female Pipe Thread	\$303.11
5537-2E1-63A	12V	17	5.3	60	Bypass	Viton®	Santoprene	1/2" Female Pipe Thread	\$319.24
5537-2E6-63B	12V	17	5.3	60	Bypass	Buna-N	Santoprene	1/2" Female Pipe Thread	\$319.24
5537-1E1-58C	115V	1.5	5.3	60	Demand	Viton®	Santoprene	1/2" Female Pipe Thread	\$403.13
5538-1E1-94A	12V	24.5	7.0	60	Demand	Viton®	Santoprene	1/2" Female Pipe Thread	\$580.59
5538-2F1-94A	12V	30	7.0	70	Bypass	Viton®	Santoprene	1/2" Female Pipe Thread	\$580.59
5538-2E6-94A	12V	30	7.0	70	Bypass	Buna-N	Santoprene	1/2" Female Pipe Thread	\$580.59
5917-9E1-63B	12V	16	5.3	60	Flo IQ	Viton®	Santoprene	3/4" Quick Attach	\$335.37

QUICK ATTACH FITTINGS

PART NUMBER	DESCRIPTION	MATERIAL	LIST PRICE
FQ5S-38	3/4" Quick Attach x 3/8" Hose Barb Straight w/ O-ring	Poly	\$4.78
FQ5S-12	3/4" Quick Attach x 1/2" Hose Barb Straight w/ O-ring	Poly	\$6.54
FQ5S-34	3/4" Quick Attach x 3/4" Hose Barb Straight w/ O-ring	Poly	\$7.42
FQ5E-38	3/4" Quick Attach x 3/8" Hose Barb Elbow w/ O-ring	Poly	\$4.78
FQ5E-12	3/4" Quick Attach x 1/2" Hose Barb Elbow w/ O-ring	Poly	\$4.91
FQ5E-34	3/4" Quick Attach x 3/4" Hose Barb Elbow w/ O-ring	Poly	\$6.98
FQ5S-12B	3/4" Quick Attach x 1/2" Hose Barb Straight w/ O-ring	Black Nylon	\$6.54
FQ5E-12B	3/4" Quick Attach x 1/2" Hose Barb Elbow w/ O-ring	Black Nylon	\$6.98
QTS-556	3/4" Quick Attach x 1/2" Male Pipe Thread Straight w/ O-ring	Black Nylon	\$6.36
FQ5ME-12	3/4" Quick Attach x 1/2" Male Pipe Thread Elbow w/ O-ring	Black Nylon	\$6.98
FQ5TS-12	3/4" Quick Attach x 1/2" OD Tube Straight w/ O-ring	Black Nylon	\$8.29

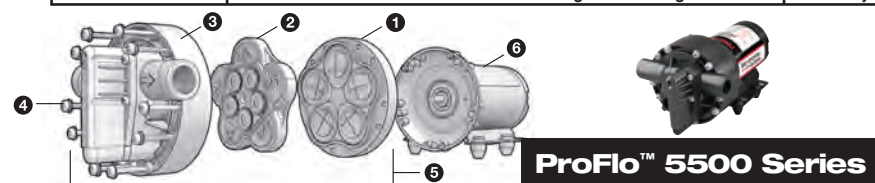

ProFlo™ 5500 Series

REF NO.	PART NO.	DESCRIPTION	LIST PRICE
1	LHA-5513-1E77	Lower Housing Assembly (Demand or Bypass)	\$71.92
2	VHA-5513-1E77	Valve Housing Assembly (Demand or Bypass)	\$64.27
3	UHA-5513-1E77	Upper Housing Assembly (Threaded/Demand)	\$79.06
3	UHA-5513-2E77	Upper Housing Assembly (Threaded/Bypass)	\$79.06
5	5513-1X77	Complete Pump Head Assembly (Demand)	\$151.15
5	5513-2X77	Complete Pump Head Assembly (Bypass)	\$151.15
6	M582-S	12 VDC Motor (w/2 Pin Connector, No On/Off Switch)	\$90.96
N/S	PSW-580R-60	5500 Series Relay Switch	\$49.91

**CATALOG IS LIST PRICE
PLEASE APPLY DISCOUNT**



MODEL	PSI	GPM	AMPS
5517 5537	0	5.30	8.00
	10	5.11	9.50
	20	4.75	11.00
	30	4.30	13.00
	40	3.85	15.00
	50	3.40	17.00
	60	3.00	18.00
	70	2.55	19.00
	80	2.25	19.75
	90	2.05	20.75
100	2.00	22.00	

MODEL	PSI	GPM	AMPS
2452	0	1.60	2.00
	10	1.40	2.50
	20	1.35	3.00
	30	1.15	3.25
	40	1.00	3.50
	50	0.95	3.75
	60	0.85	3.75
	70	0.75	4.00
	80	0.60	4.25
	90	0.45	4.50
100	0.40	4.75	

MODEL	PSI	GPM	AMPS
5538	0	7.00	11.00
	10	6.80	12.00
	20	6.45	12.00
	30	5.90	13.00
	40	5.50	15.00
	50	4.95	17.00
	60	4.40	19.00
	70	3.95	21.00
	80	3.50	23.00
	90	3.05	24.00
100	2.55	25.00	

MODEL	PSI	GPM	AMPS
3313	0	2.20	3.50
	10	2.00	4.50
	20	1.95	5.00
	30	1.70	5.50
	40	1.60	6.00
	50	1.55	7.00
	60	1.45	7.50
	70	1.40	8.00
	80	1.35	8.75
	90	1.25	9.50
100	1.00	10.00	

MODEL	PSI	GPM	AMPS
5917 5937	0	5.30	8.00
	10	5.11	9.50
	20	4.75	11.00
	30	4.30	13.00
	40	3.85	15.00
	50	3.40	17.00
	60	3.00	18.00
	70	2.55	19.00
	80	2.25	19.75
	90	2.05	20.75
100	2.00	22.00	

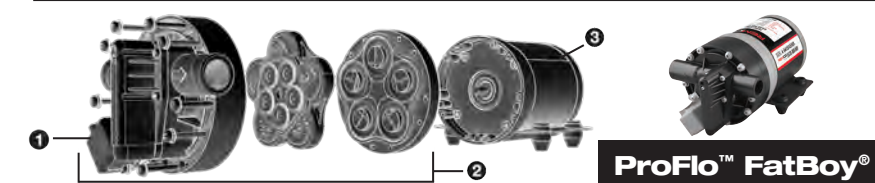

ProFlo™ FatBoy®

REF NO.	PART NO.	DESCRIPTION	LIST PRICE
1	FBS-100	Relay Switch (20-267)	\$48.92
2	PH-5538E-D	Complete Pump Head Assembly (Demand)	\$298.40
2	PH-5538E-B	Complete Pump Head Assembly (Bypass)	\$298.40
3	70-594-00	12 VDC Motor (Lead Wire Only)	\$408.07



WEMC 250 **NEW**

Wireless Electric Motor Control

The **NEW** 12 volt **Wireless Electric Motor Control Console**. The idea of a simple motor control with added wireless technology allows the console to compensate for pressure changes effortlessly. This automatically reduces over application and pressure spikes.

FEATURES:

- **Wireless Operation:** Completely wireless from the cab to the implement. No fluid for pressure display running into the cab.
- **Automatic Pressure Compensation:** Quick, smooth pressure recovery to desired set point.
- **Wireless Digital Pressure Readout:** Backlit for easy day or night visibility & reference set point.
- **Section Control:** Will control up to 4 boom sections wirelessly by the push of a button.
- **Simple Install:** Minimal programming required. Cab unit simply plugs into any switched 12v power source. The implement unit connects into any 30amp 12v power source.
- **Easy Operation:** Start up screen verifies that wireless communication has been established. To begin simply turn on each boom, press the master switch, then press the up or down arrow to set desired pressure.
- **Fuse Protection:** Both the in cab box & implement box are reverse polarity and fused protected.
- **Durable:** Both boxes and all control buttons are water resistant & durable for long term use.
- **Optional Functions:** Unit is programmable for PWM or PWM close functions.
- **MADE IN THE USA**

WHAT YOU GET:

One cab unit, one implement unit, one power supply cable (10' • red & black wires) and one motor supply cable (15' • green & white wires).

OPTIONAL ADD ON:

- Four section shut off cable
- A whisker switch can easily be added for automatic on/off control as implement is lifted/lowered

WIRELESS ELECTRIC MOTOR CONTROL		
Part#	Description	Price
505WEMC250	Wireless Electric Motor Control Premium Package	\$1,889.84
505315124	Cable, 12' WEMC 4 Section Final	\$338.96
215652	10' Battery Cable (Included in Kit) - Metri-Pack	\$76.04
215650	15' Motor Cable (Included in Kit) - Metri-Pack	\$88.57
215651	15' Motor Extension Cable - Metri-Pack	\$103.33
216012	Remote whisker switch with cable	\$508.11



12 VOLT PUMP CONTROLLER

Self contained pump speed control unit for 12v pumps with a Stainless Steel pressure gauge or digital gauge. Complete with 10' battery cable, 15' motor cable, 15' motor cable extension and gauge tubing. 35 amp only. Built in relay switch for easy whisker switch installation.



12 VOLT PUMP CONTROLLER		
Part#	Description	Price
3BEC35-SSGKITMP	12 Volt Controller Kit w/ SS Pressure Gauge	\$657.29
3BEC35-DDKITMP	12 Volt Controller Kit with Digital Gauge	\$901.69
REPLACEMENT PARTS		
MSC-30SSG-I	Replacement Console Only (SS Pressure Gauge)	\$624.64
MSC30DD-I	Replacement Console Only (Digital Gauge)	\$765.78
215652	10' Battery Cable; Metri-Pack	\$76.04
215650	15' Motor Cable; Metri-Pack	\$88.57
215651	15' Motor Extension Cable; Metri-Pack	\$103.33
217012	Pressure Transducer (Digital Only); Weather-Pack	\$110.93
216012	Remote whisker switch with cable	\$508.11